

“Shën Pjetri” Stan Tërg-Mitrovicë



Zgjerimi dhe Rekonstruimi Ideal

Punuan: Gresa Kuleta, Leunita Syla







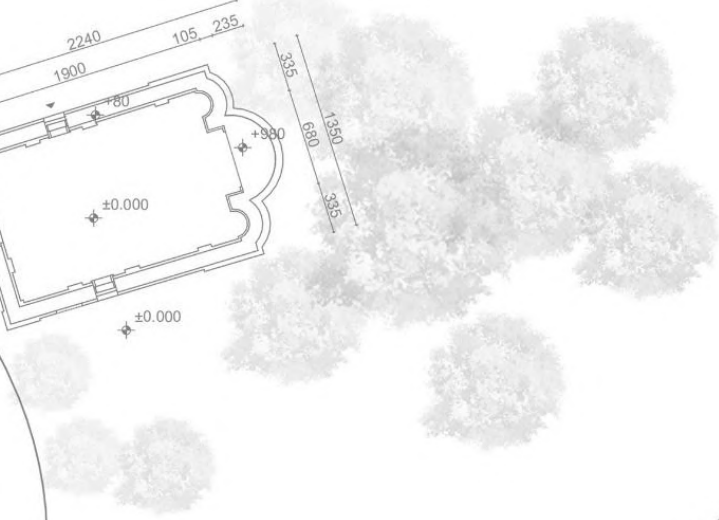
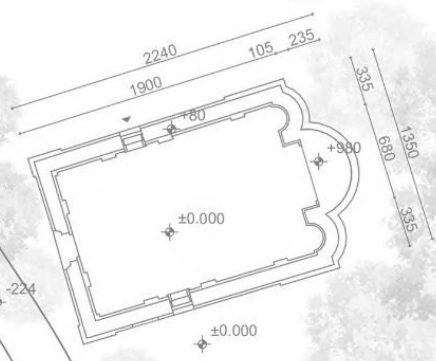
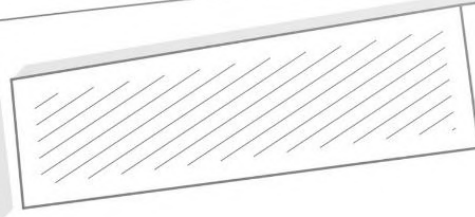
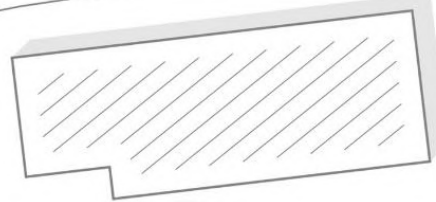
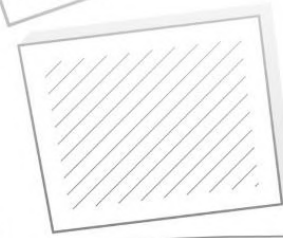

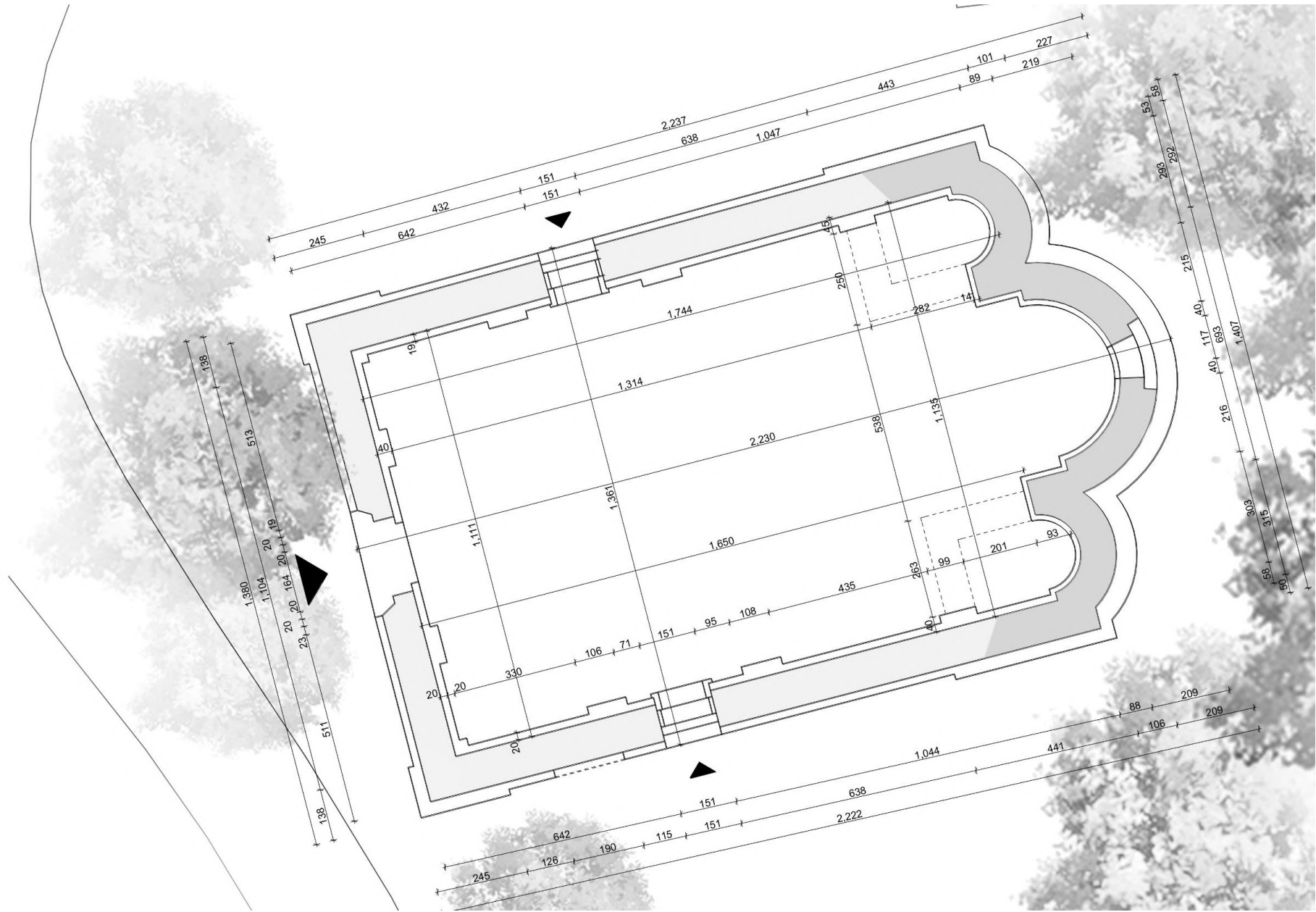

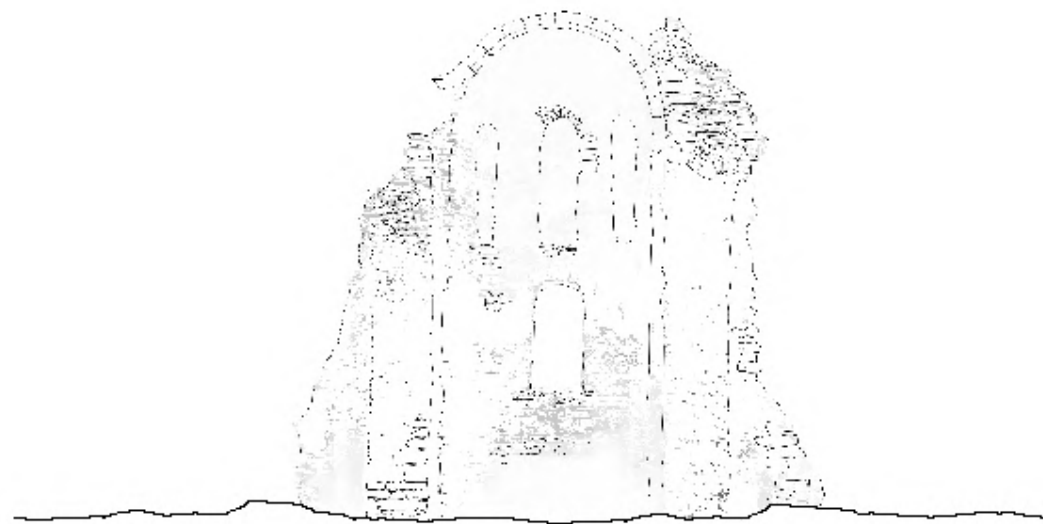

fasada ballore

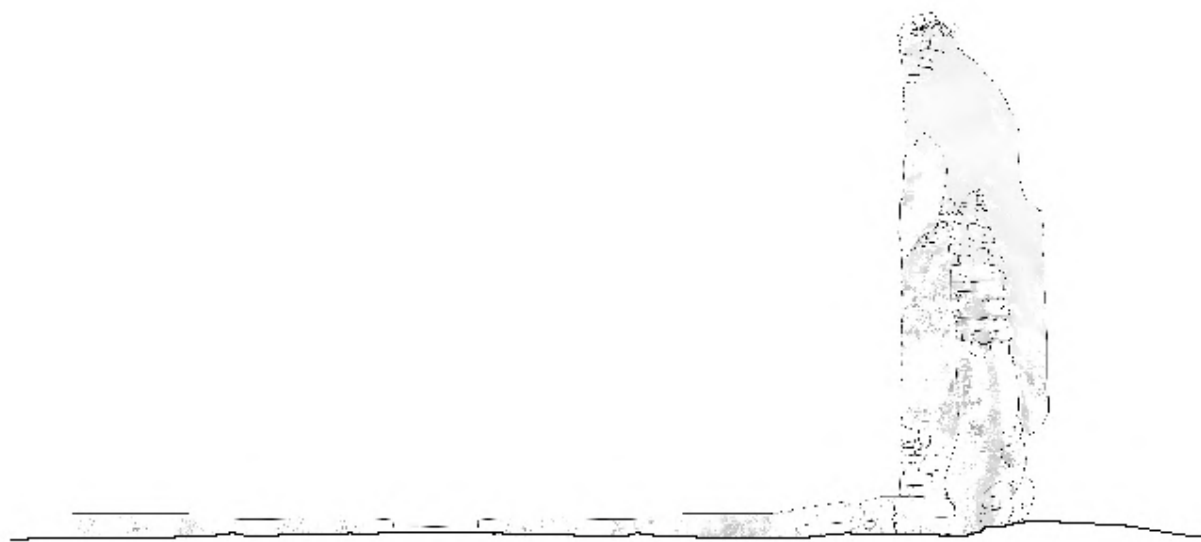

fasada ansore

Kisha e Shen Kollit – Perhondi (shek. XI-XIV)



Kishat Anglo-Saksone ne Angli

- Kisha “Escomb “



- Kisha “Wittering “





detaj i deres kryesore te kisha anglo-saksone "escomb"



kisha brixworth (northans) e cila cilesohet si kisha me fine anglosaksone me tri anijata . ndahet me shtylla dhe harqe.

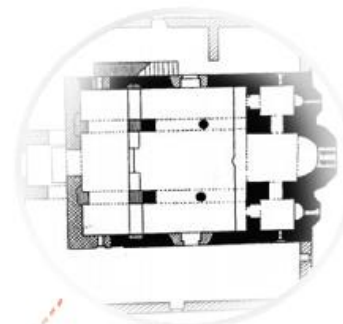

kisha trianjatesh e shen kollit ne perihondi shek. XI-XIV

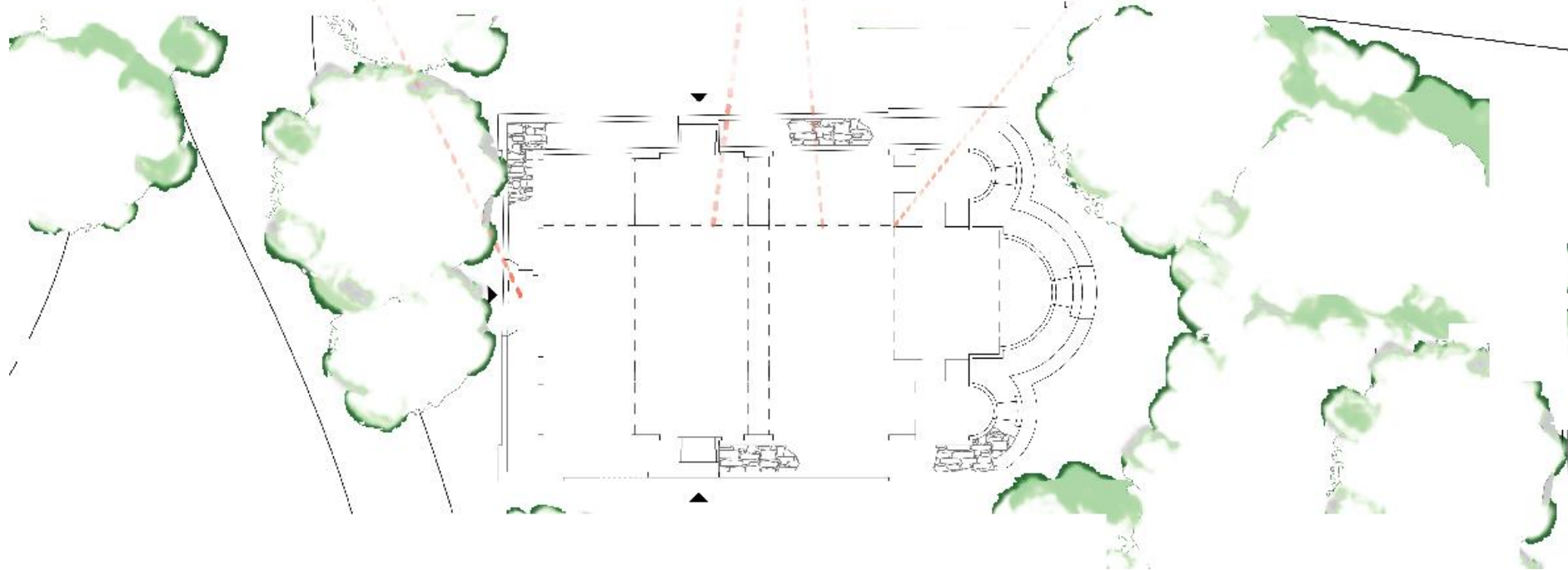



"bigstone cornering" apo muratimi i qosheve me gure te medhenje ishte stil kryesor i kishave te hershme anglo-saksone.



dëra jugore "dëra e djallit" sipas supersticioneve te popullit, ne kishes anglo-saksione "kirk hammerton".



dritare e thjeshte saksone e vedonsur ne pjeset me ta larta te kishes "escomb".

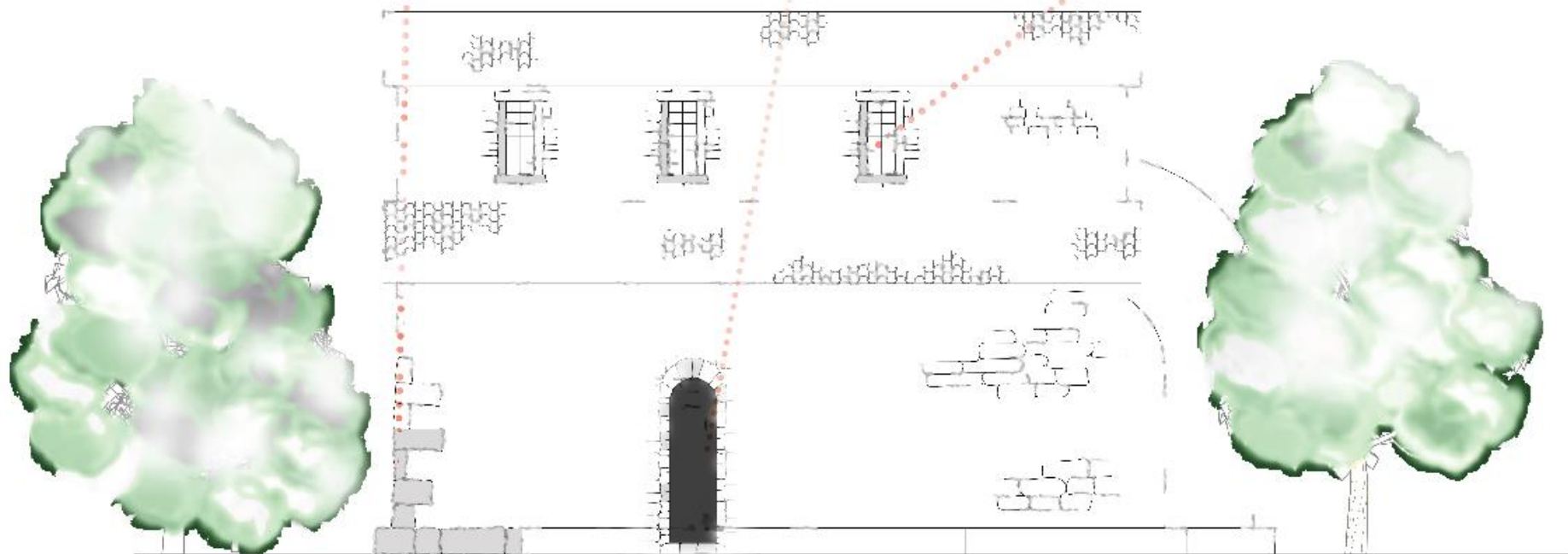

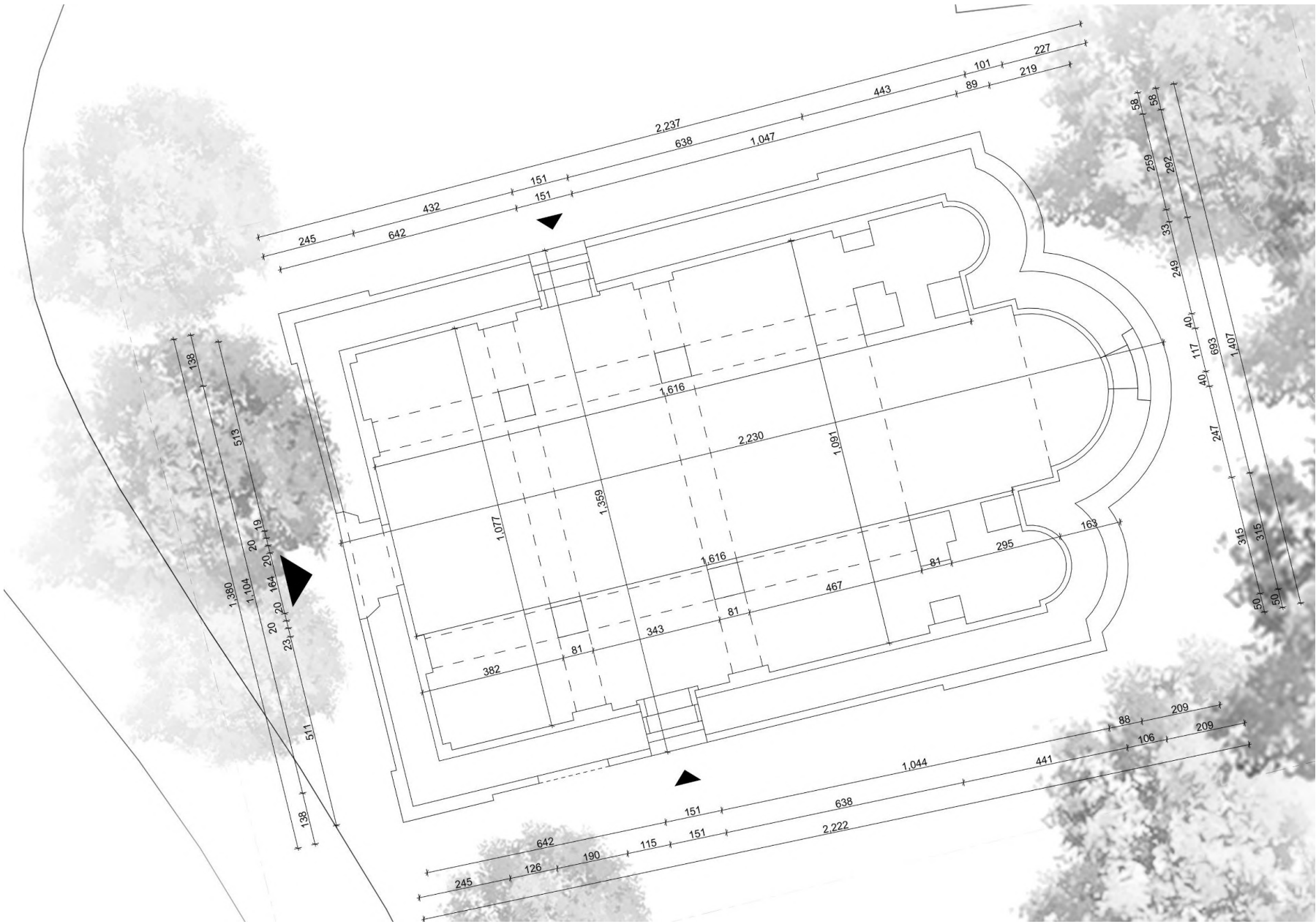



- Kisha ne Puglia – Eduardo Tresoldi



- “Reja” – Sou Fujimoto

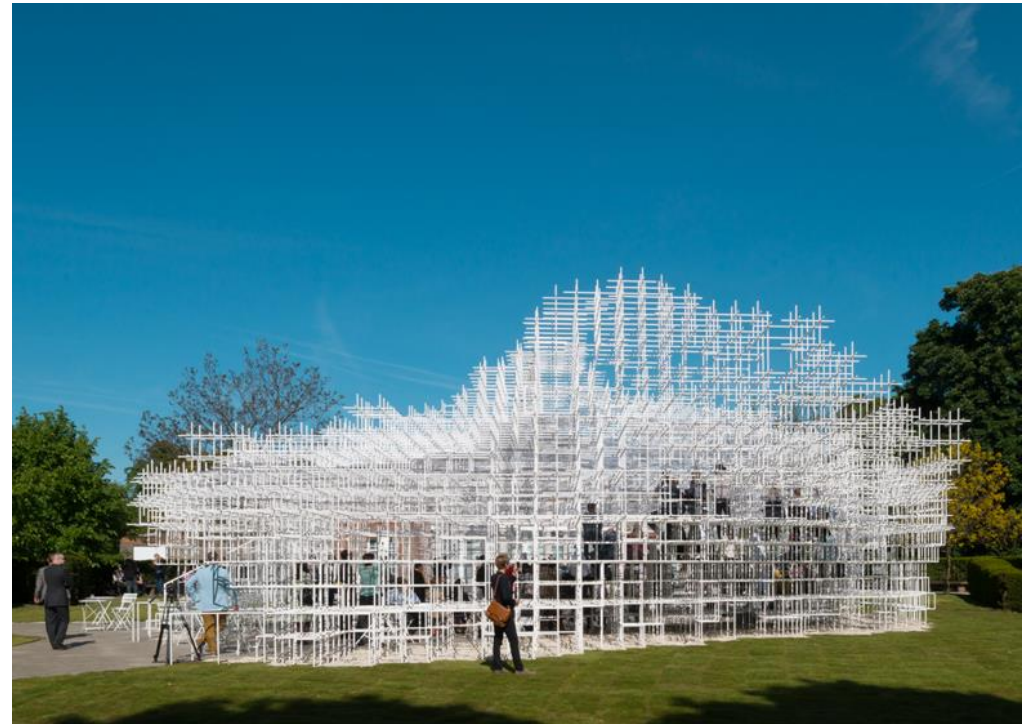

TRIADA VITRUVIANE

